

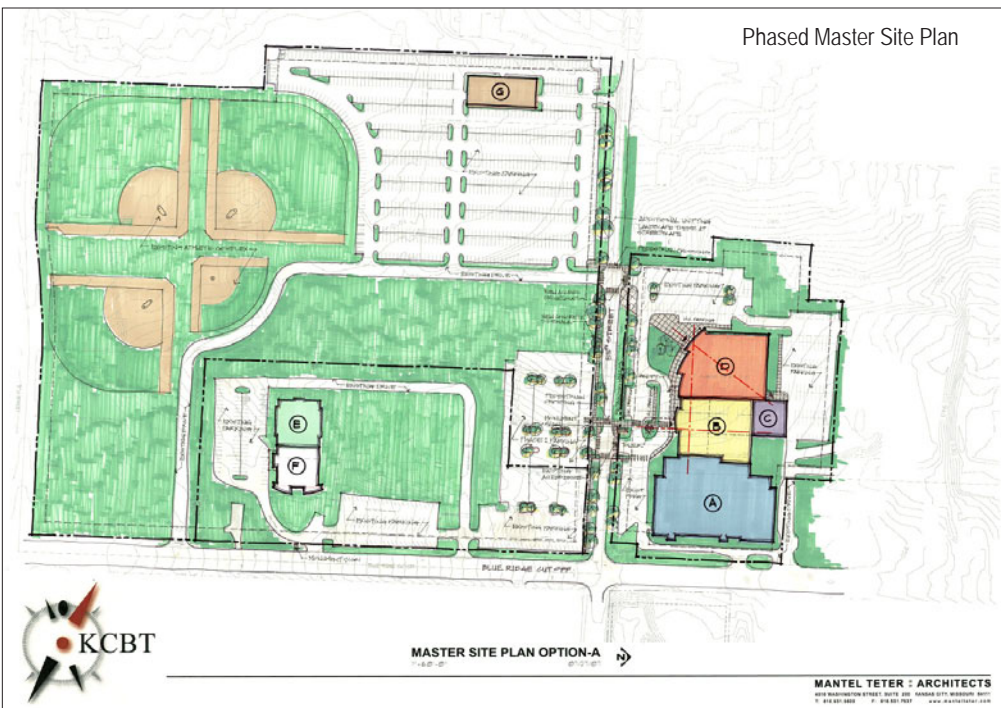

KANSAS CITY BAPTIST TEMPLE



Client:
Kansas City Baptist Temple

Location:
5460 Blue Ridge Cut-Off
Kansas City, Missouri

Size:
45,000 S.F. (Building Addition)

Services Provided:
Programming (Strategic Dimensions)
Master Planning
Architectural
Civil Engineering
Structural Engineering
M/E Engineering
Interior Design
Fire Suppression Engineering
Landscape Design
Acoustical Design
Technical Systems Design
Construction Administration

Construction:
A combination of brick veneer to match the existing building with precast concrete panels and architectural metal panels with metals studs and a structural steel post-beam frame.

Reference:
Jeff Cox, Executive Pastor
816.358.0988

Kansas City Baptist Temple is in the heart of Kansas City and Raytown, sharing a city limits line that actually runs through their facilities! Spinning from a recently failed attempt to launch a building project, the church re-analyzed their needs. To lead and facilitate this process, they called upon Mantel Teter Architects and their strategic planning partner, Strategic Dimensions. Together the church leadership was able to express their ministry goals and evaluate different scenarios of building and funding options to meet those ministry goals. A very “doable” project and direction was found and Mantel Teter Architects began master planning and schematic design drawings to assist the key leadership of the church in casting the vision.

The project includes a new building addition that provides desperately needed fellowship and community space to have conversation and connection with others. A new fellowship café and expanded bookstore are also included. A major space need is nursery/preschool and children. Their new plan provides state of the art rooms with incredible flexibility with amenities such as auditorium space, play space, and ministry rooms. The design includes important safety features such as check-in points and security control system.

The leadership has a strong desire to improve the architectural appearance of the entire campus facility and even plan for improvements to the existing facility facades. Mantel Teter Architects included a new main entry with unloading canopy and outdoor patio fellowship space. The space is designed to easily expand with the next building phase, a 1,500 seat Auditorium.

