

*“The building presents a very dynamic appearance to the community. Our new building can be seen from many miles away, from several directions.”*

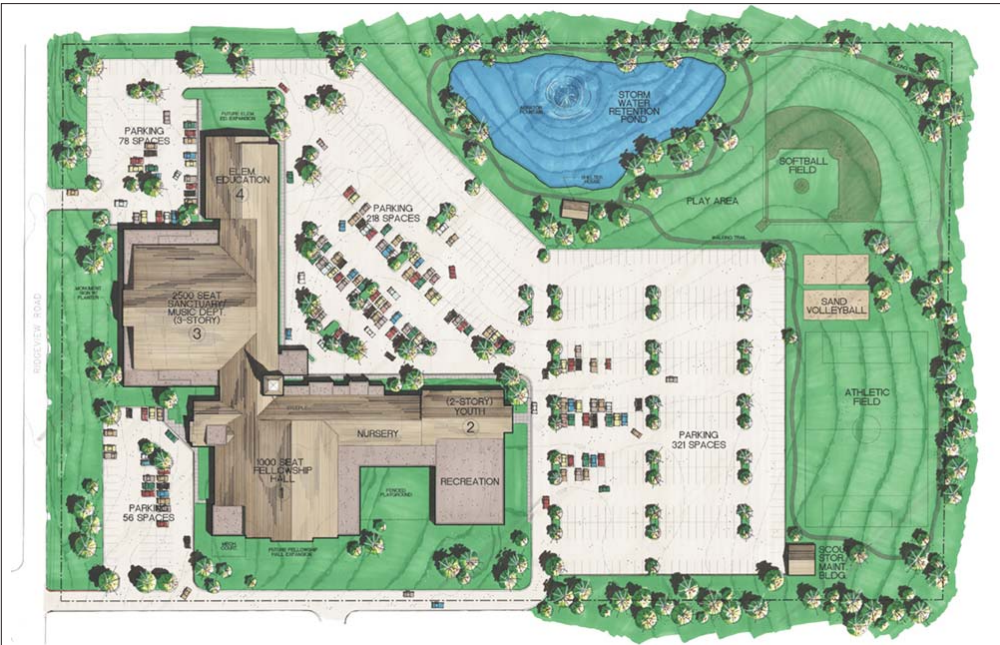

## GRACE UNITED METHODIST CHURCH



This phase I facility for Grace United Methodist Church is comprised of numerous multipurpose areas, a music department, staff offices, a large foyer and Sunday School classrooms. The largest multipurpose room is designed to accommodate 1,000 in worship, and will ultimately serve as a fellowship dining hall for 600.

The material and design considerations for the facility address both the traditional and contemporary philosophies of this congregation's mission. The master plan includes additional educational and recreational facilities, as well as a dramatic sanctuary that seats 2,500.



**Client:**  
Grace United Methodist Church

**Location:**  
11485 North Ridgeview Road  
Olathe, Kansas

**Size:**  
47,000 S.F.

**Services Provided:**  
Programming  
Master Planning  
Architectural  
Civil Engineering  
Structural Engineering  
M/E Engineering  
Interior Design  
Cost Estimating  
Acoustical Design  
Technical Systems Design  
Landscape Architecture

**Construction:**  
Brick, synthetic insulated stucco, aluminum, glass with cast stone accents, structural steel frame with metal stud in fill, asphalt shingles over insulated metal deck, aluminum steeple and cross.

**Reference:**  
Bob Jewell, Bldg. Comm. Chair  
913.492.3055

*“The interior spaces have provided us with many opportunities for expanded programming that could not be done before. It has allowed us to expand our Sunday school program. It has provided much better space for the staff. The multi-purpose space allows us to hold much larger gatherings than ever before. We enjoy the new church and look forward to what the future may bring.”*

Dennis Doles, Project Manager  
Grace United Methodist Church